

order number	lens name
0703-005-000-40	Apo-Rodagon-D 1x 4/75

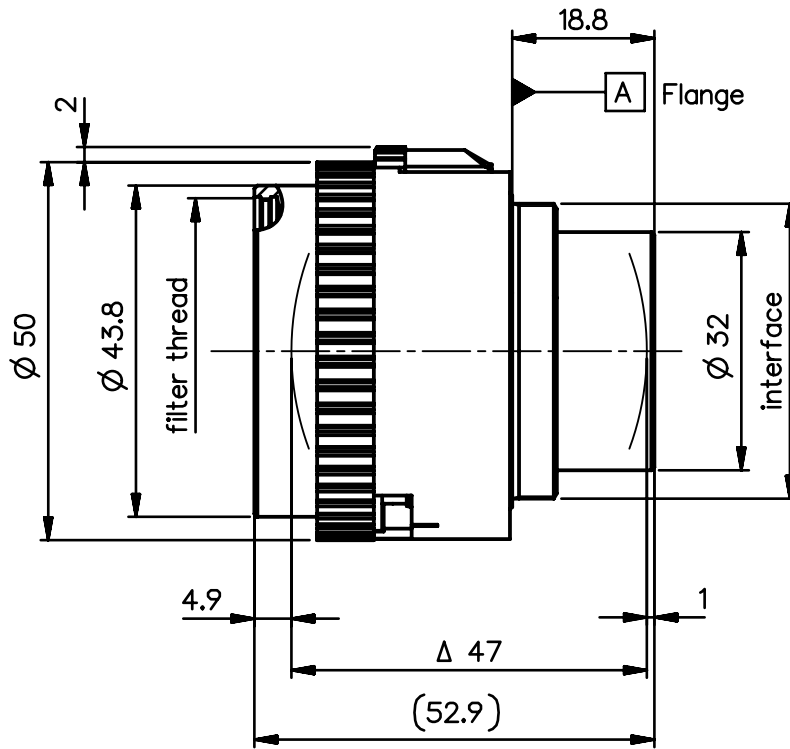

Specification	ON	8501-9002	
image circle max. (mm)	82	working distance (mm)	100 - 130
focal length f' (mm) *	74.9	interface	M39 x1/26" (Leica)
magnification β' [range]	-1 [-1.2 ... -0.8]	filter thread	M40.5 x0.5
spectral range λ (nm)	400 - 750	weight (g)	130

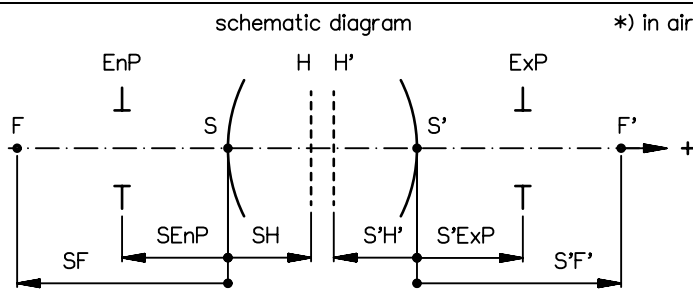

design includes CCD cover glass:	no			
SF (mm)	-44.2	f-stop	\varnothing EnP	\varnothing ExP
S'F' (mm) *	44.2	4	18.7	18.7
HH' (mm) *	-14.35	5.6	13.4	13.4
SH (mm)	30.7	8	9.4	9.4
S'H' (mm) *	-30.7	11	6.8	6.8
SEnP (mm)	30.7	16	4.7	4.7
S'ExP (mm) *	-30.7	22	3.4	3.4

NX	EU-D	AL-T1A	US-D	US-ML	not export controlled		
				PDM Status Freigabe	-		
PROTECTIVE NOTE "DIN ISO 16016" TO BE OBSERVED	REV	ECC	DATE	APPROVED	GENERAL TOLERANCE OF DIMENSION, FORM, POS.	SURF. TREATMT	SCALE 1:1
	a	Neuausg	05.08.14	Schiff			MATERIAL
							TITLE
							Apo-Rodagon-D 1x 4/75
							FIRST DATE NAME
							ISSUE 05.08.14 Schifferer
							CHKD 05.08.14 Stauder
DIN A 4	ALL DIMENSIONS ARE IN MM AND INCLUDE SURFACE TREATMENT			 		DRAWING NO.	SHEET 1
						0703-005-100-00-0001a	OF 1
						REPLACES	

Apo-Rodagon_D1

MTF at ratio 1.0x f/ 4.0

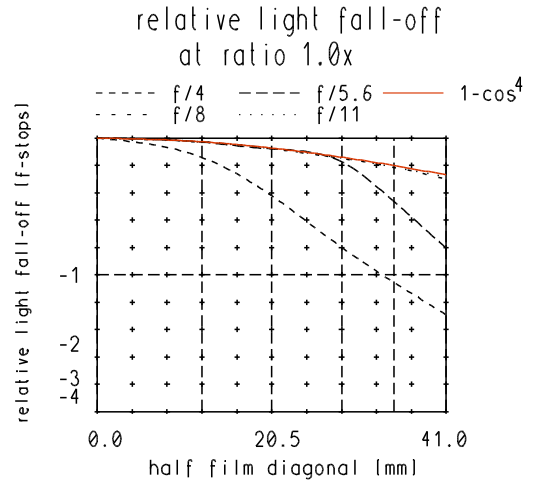
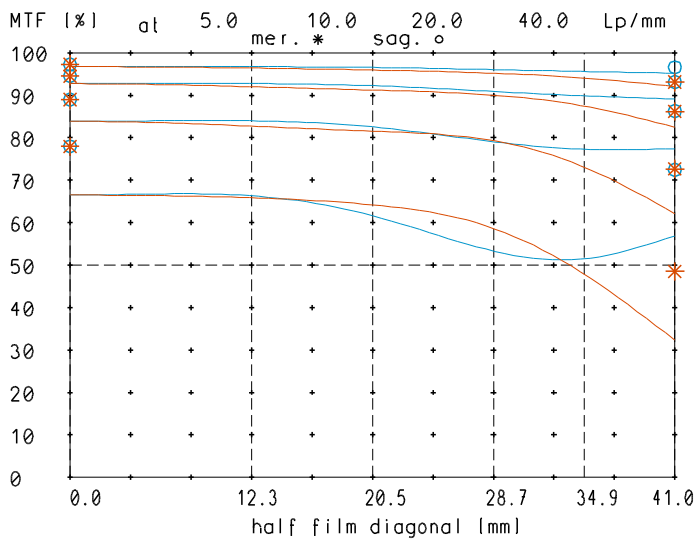

MTF at ratio 1.0x f/ 8

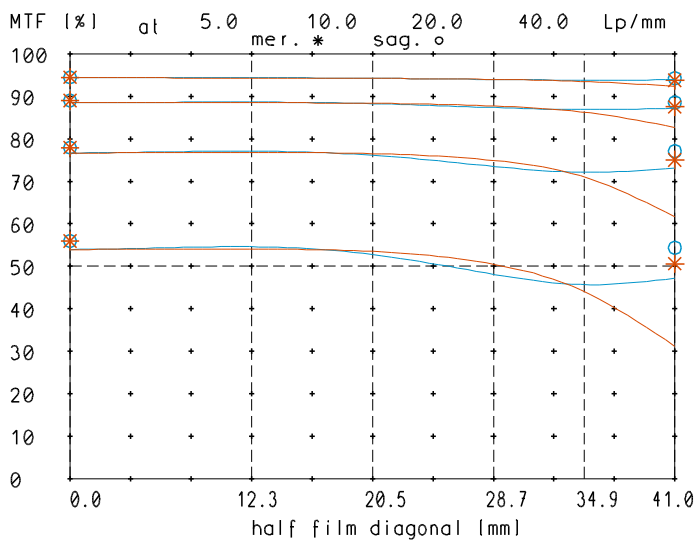

Distortion at ratio 0.7x to 1.2x

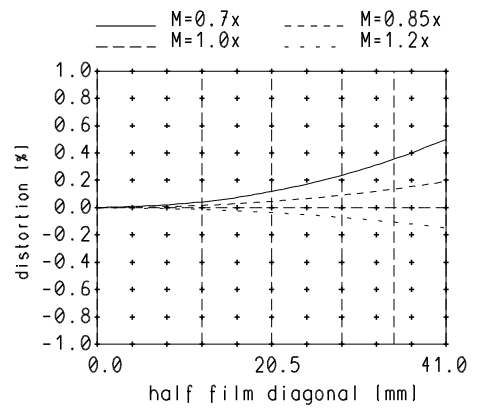

— sagittal, o Diffraction limited value
— meridional * Diffraction limited value

Longitudinal color aberration at ratio 1.0x

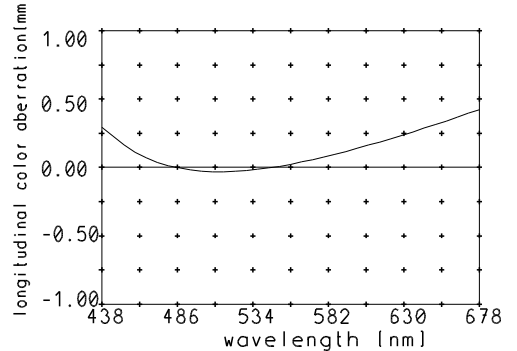

Named frequencies (line pairs/mm) in modular transfer function (MTF) as well as diagrams of relative light fall-off, distortion and longitudinal color aberration refer to film plane.