

REVISIONS RECORD				
REV.	ECN	DESCRIPTION	CHG BY DATE	APR. BY DATE
A		RELEASED	GS 12NOV12	PD 12NOV12

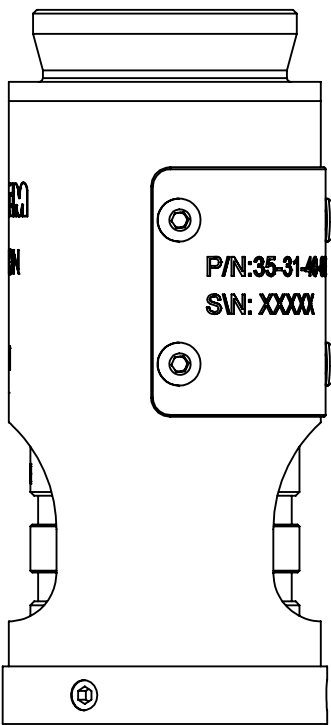
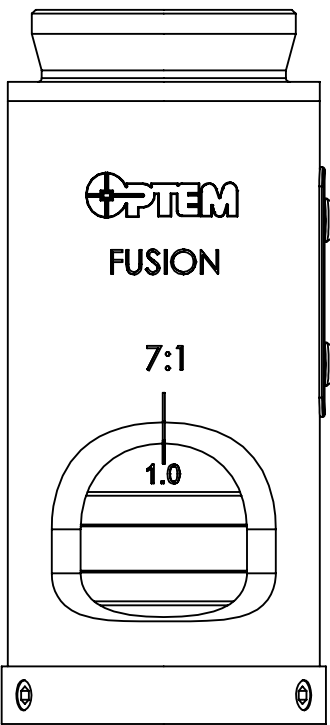
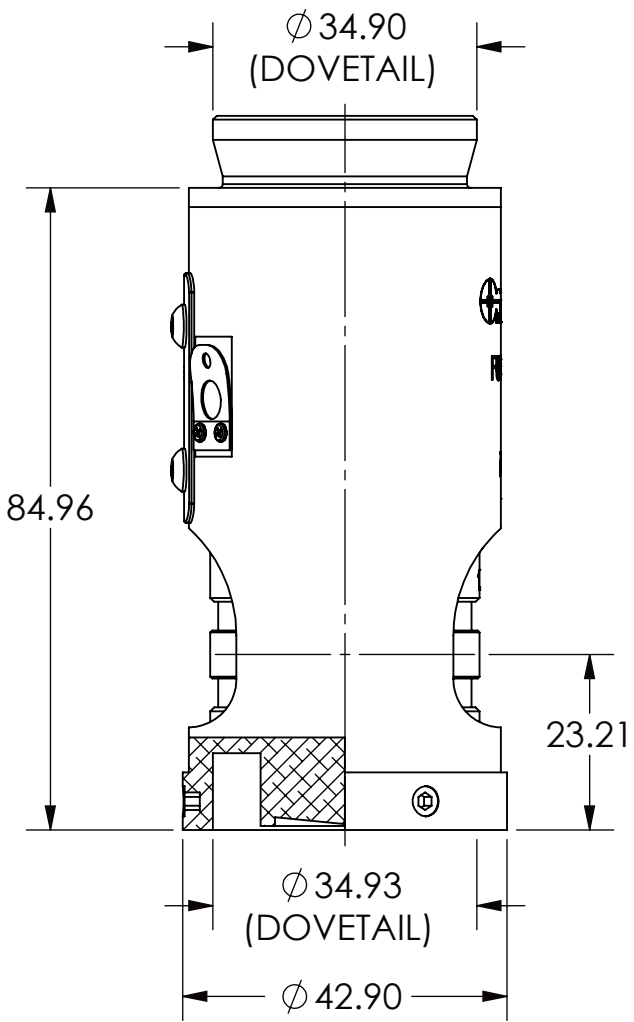
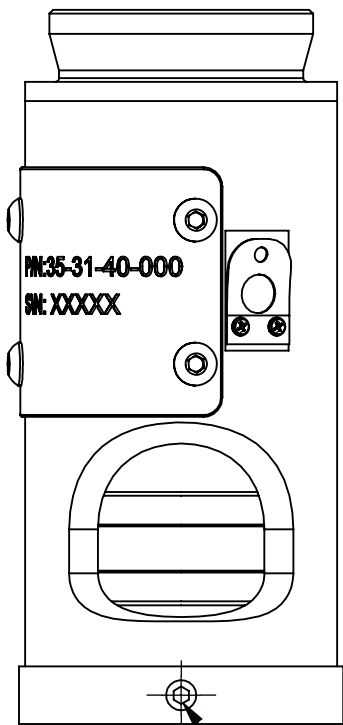

2MM HEX

ALL DIMENSIONS ARE FOR REFERENCE ONLY

MATERIAL:	THIS TECHNICAL DATA IS CONTROLLED UNDER THE EXPORT ADMINISTRATION REGULATIONS AS EAR99 AND MAY NOT BE EXPORTED TO A FOREIGN PERSON, EITHER IN THE U.S. OR ABROAD, WITHOUT THE PRIOR WRITTEN APPROVAL OF QIOPTIQ, INC. OR AUTHORIZATION OF THE U.S. DEPARTMENT OF COMMERCE.	THREAD CLASS: -2A, -2B CHAMFER THREADS 30° TO ROOT DIA	DRAWN: G.SCHENKER 12NOV12	HTS CODE 9002.11.6000
FINISH:			APPROVED: P.DILLON 12NOV12	SCALE: 1:1

UNLESS OTHERWISE SPECIFIED
ALL DIMENSIONS ARE IN
MILLIMETERS

UNTOLERANCED DIMENSIONS
.XX = ±0.13
.X = ±0.3
ANGLES = ±0°30'
CONCENTRICITY=0.08 TIR
BREAK ALL SHARP EDGES:
0.13 MIN, 0.26 MAX
MAX SURFACE
ROUGHNESS 0.8

0.0 inch 1.0
0.0 mm 25.0

SOLIDWORKS

QIOPTIQ
Photonics for Innovation

Qioptiq, Inc.
78 Schuyler Baldwin Drive
Fairport, NY 14450 USA

THIS DOCUMENT IS THE PROPRIETARY INFORMATION OF QIOPTIQ, INC. ITS USE IS AUTHORIZED ONLY FOR RESPONDING TO REQUEST FOR QUOTATION OR PERFORMANCE OF WORK FOR QIOPTIQ, INC.

TITLE: 7:1 ZOOM, DETENT
OUTLINE DRAWING

SIZE B DWG NO: 35-31-40-000

REV A